

| | |
|---------------------|---|
| Product description | M16 IP67 female angled connector, Contacts: 6 DIN, 6.0 - 8.0 mm, shieldable, solder, IP67, UL |
| Area | M16 IP67 series 423 |
| Order number | 99 5622 75 06 |

Illustration

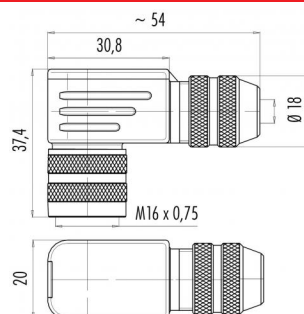

Scale drawing



Contact arrangement (Plug-in side)

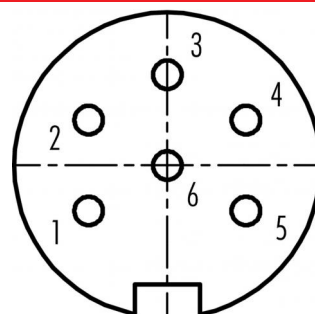

You can find the component part drawing and assembly instructions on the next page.

Technical data

General features

| | |
|---------------------------|---|
| Order number | 99 5622 75 06 |
| Connector design | female angled connector |
| Version | connector female angled screw |
| Connector locking system | solder |
| Termination | IP67 |
| Degree of protection | max. 0.75 mm ² / max. AWG 18 |
| Cross-sectional area | 6.0 - 8.0 mm |
| Cable outlet | 90° (4 coding options) |
| Twistability | -30 °C / 95 °C |
| Temperature range from/to | > 500 Mating cycles |
| Mechanical operation | 66.71 |
| Weight (g) | 85369010 |
| Customs tariff number | |

Electrical parameters

| | |
|---------------------------|----------------------|
| Rated voltage | 250 V |
| Rated impulse voltage | 1500 V |
| Rated current (40 °C) | 5 A |
| Insulation resistance | ≥ 10 ¹⁰ Ω |
| Pollution degree | 1 |
| Overvoltage category | I |
| Insulating material group | III |
| EMC compliance | shieldable |
| Shield connection | shield ring |

Material

| | |
|-----------------------|----------------------|
| Contact body material | PBT (UL94 V-0) |
| Contact material | CuSn (bronze) |
| Contact plating | Ag (silver) |
| REACH SVHC | CAS 7439-92-1 (Lead) |

Classifications

| | |
|-------------|-------------|
| eCl@ss 11.1 | 27-44-01-02 |
| ETIM 7.0 | EC002635 |

Declarations of conformity

| | |
|-----------------------|---|
| Low Voltage Directive | 2014/35/EU (EN 60204-1:2018; EN 60529:1991) |
|-----------------------|---|

| | |
|---------------------|---|
| Product description | M16 IP67 female angled connector, Contacts: 6 DIN, 6.0 - 8.0 mm, shieldable, solder, IP67, UL |
| Area | M16 IP67 series 423 |
| Order number | 99 5622 75 06 |

Component part drawing

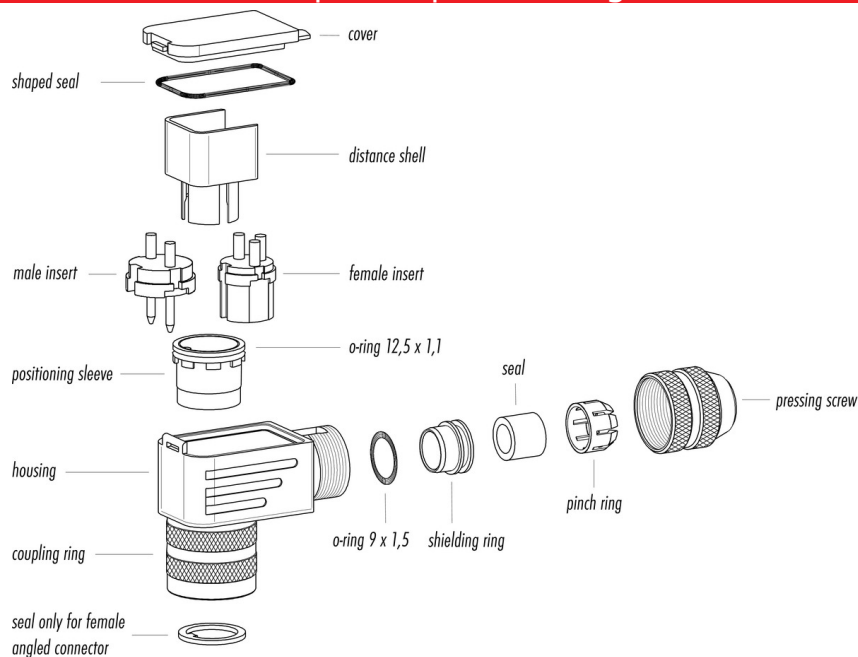

Assembly instructions / Panel cut-out

Angled version

1. Assemble sealing rings (3x).
2. Bead cable parts.
3. Dismantle cable and shielding braid.
4. Push single wires through housing.
5. Mount shielding ring and pinch ring.
6. Slightly fix pressing screw.
7. Solder wires to insert.
8. Mount positioning sleeve in angled position.
9. Put in insert and distance sleeve.
10. Mount lid.
11. Fix pressing screw (1.25 Nm).

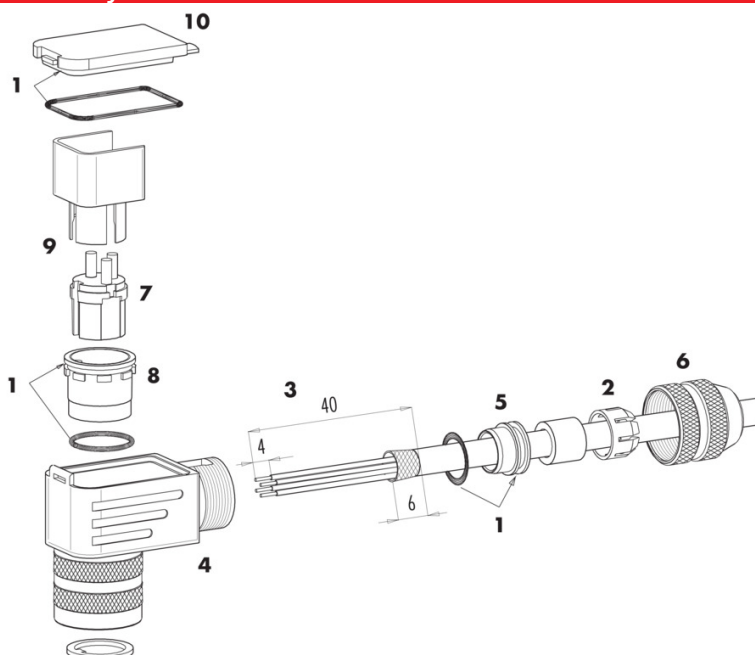

| | |
|---------------------|---|
| Product description | M16 IP67 female angled connector, Contacts: 6 DIN, 6.0 - 8.0 mm, shieldable, solder, IP67, UL |
| Area | M16 IP67 series 423 |
| Order number | 99 5622 75 06 |

Security notices

The connector must not be plugged or unplugged under load. Non-observance and improper use can result in personal injury.

The connectors have been developed for applications in plant engineering, control and electrical equipment construction. The user is responsible for checking whether the connectors can also be used in other areas of application.

Connectors which are used in circuits with voltages dangerous to the touch may only be installed and used by, or under the supervision of, persons with electrical engineering training, taking into account the applicable regulations and standards.

Plug connectors with enclosure protection IP 67 and IP 68 are not suitable for use under water. When used outdoors, the plug connectors must be protected separately against corrosion. For further information on the IP protection classes, please refer to the "Technical Information" download centre. The plug connector is not suitable for mains voltages. Please observe the pollution degree and the overvoltage category. For further information, please refer to the download center "Technical Information".

To lock the cable connector with the device connector, the threaded ring is tightened "hand-tight" (approx. 50 cNm).