

| | |
|---------------------|---|
| Product description | M16 IP40 male cable connector, Contacts: 8 DIN, 6.0 - 8.0 mm, shieldable, crimp (Crimp contacts must be ordered separately), IP40 |
| Area | M16 IP40 series 581 |
| Order number | 99 2061 702 08 |

Illustration

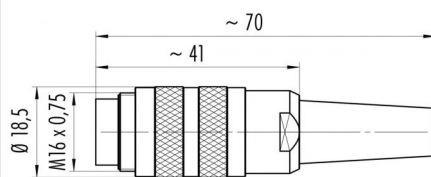

Scale drawing



Contact arrangement (Plug-in side)

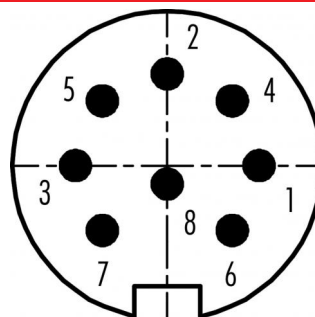

You can find the component part drawing and assembly instructions on the next page.

Technical data

General values

| | |
|--------------------------|---|
| Connector design | male cable connector |
| Connector locking system | screw |
| Termination | crimp (Crimp contacts must be ordered separately) |
| Wire gauge (mm) | see crimp contacts under accessories |
| Cable outlet | 6.0 - 8.0 mm |
| Upper limit temperature | 100 °C |
| Lower limit temperature | -40 °C |
| Customs tariff number | 85369010 |

Electrical values

| | |
|---------------------------|-----------------------|
| Rated current (40 °C) | 5 A |
| Rated voltage | 60 V |
| Rated impulse voltage | 500 V |
| Pollution degree | 1 |
| Overvoltage category | I |
| Insulating material group | III |
| Insulation resistance | $\geq 10^{10} \Omega$ |
| EMC compliance | shieldable |
| Degree of protection | IP40 |
| Mechanical operation | > 500 Mating cycles |

Material

| | |
|-----------------------|--|
| Contact material | depending on crimp contact (accessory) |
| Contact body material | PBT (UL94 V-0) |
| REACH SVHC | CAS 7439-92-1 (Lead) |

Product data sheet

Miniature connectors



| | |
|---------------------|---|
| Product description | M16 IP40 male cable connector, Contacts: 8 DIN, 6.0 - 8.0 mm, shieldable, crimp (Crimp contacts must be ordered separately), IP40 |
| Area | M16 IP40 series 581 |
| Order number | 99 2061 702 08 |

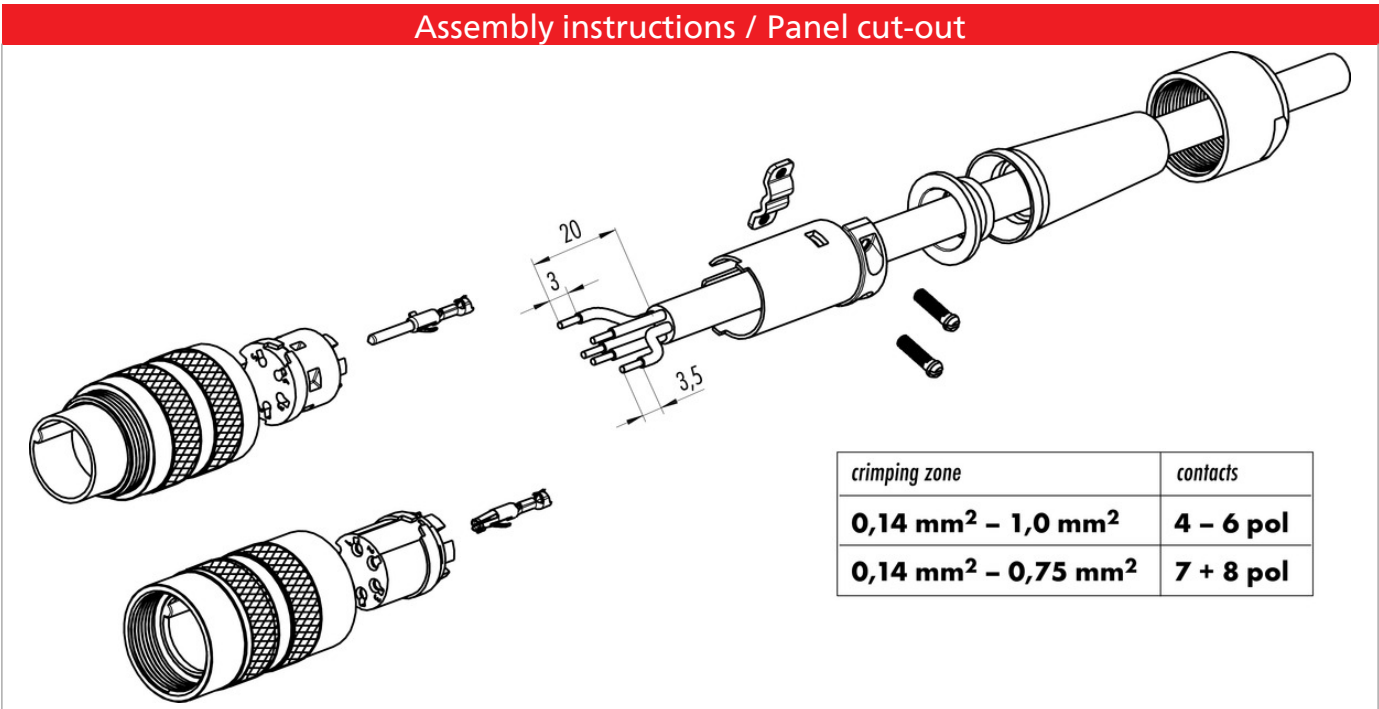
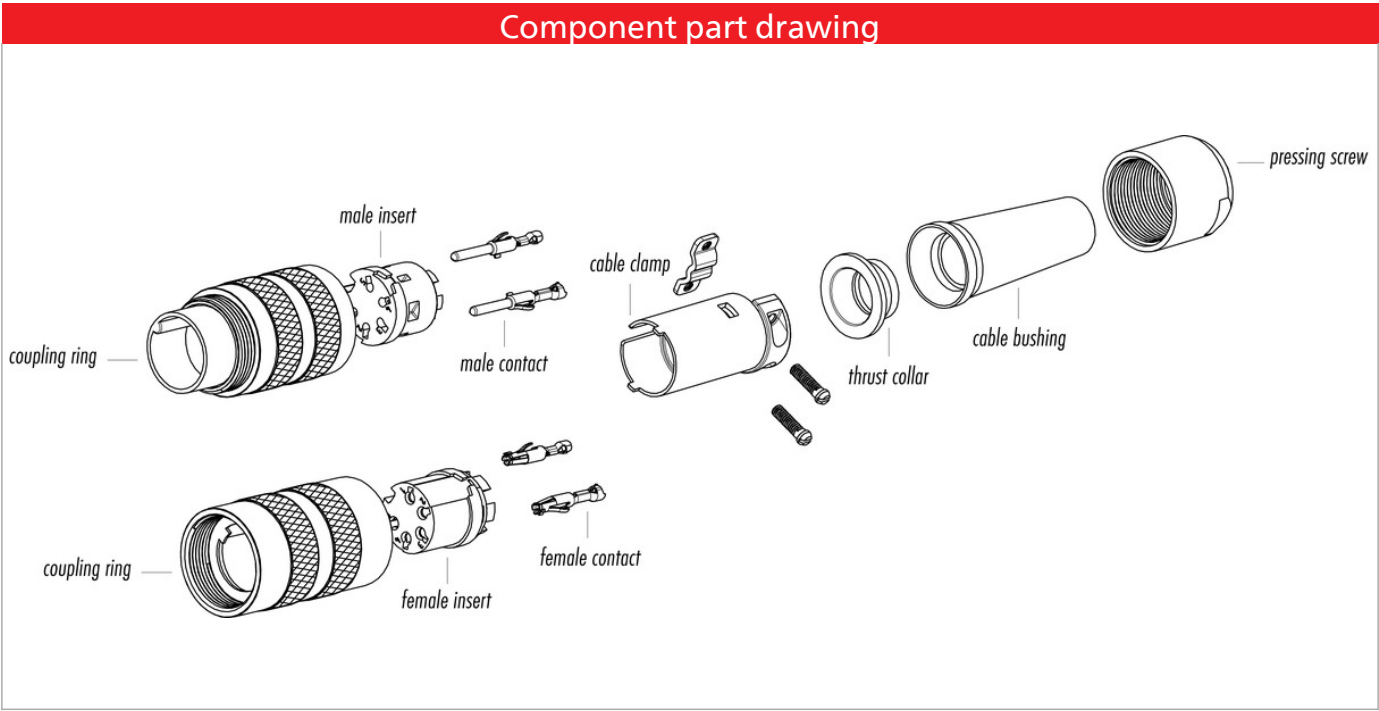

| | |
|---------------------|---|
| Product description | M16 IP40 male cable connector, Contacts: 8 DIN, 6.0 - 8.0 mm, shieldable, crimp (Crimp contacts must be ordered separately), IP40 |
| Area | M16 IP40 series 581 |
| Order number | 99 2061 702 08 |

Security notices

The connectors have been developed for applications in plant engineering, control and electrical equipment construction. The user is responsible for checking whether the connectors can also be used in other areas of application.

To lock the cable connector with the device connector, the threaded ring is tightened "hand-tight" (approx. 50 cNm).