



- Screw locking acc. to DIN EN 61076-2-101 und 109
- Degree of protection IP67
- Moulded versions
- Easy Assembly
- Excellent EMC shielding
- Versions with shielding rings/cable clamp
- Angled connectors adjustable in 4 positions

Description

Drawing

Contacts

Cable outlet

Ordering-No.

Male cable connector, CAT 5, screw clamp termination, with shielding ring, shieldable

4

6–8 mm

99 3729 810 04

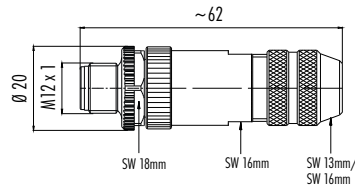

c us

Male cable connector, CAT 5, screw clamp termination, iris type spring, shieldable

4

5–8 mm

99 3727 810 04

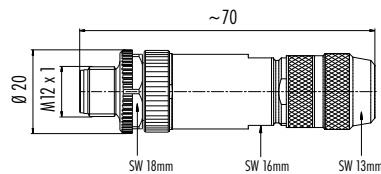

c us

Male cable connector, CAT 5, screw clamp termination, with shielding ring, stainless steel version, shieldable

4

5,5–8,6 mm

99 3729 995 04

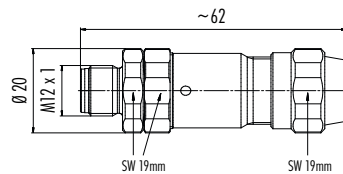

c us

Male cable connector, CAT 5, crimp connection, shieldable

4

5–8 mm

99 3721 810 04

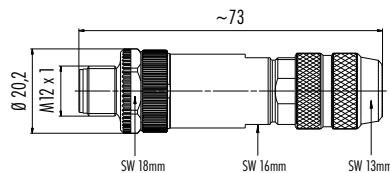

Crimp contacts see page 159

Specifications

Contacts	4
Wire gauge	max. 0,75 mm ² (max. AWG 20), see crimp contacts page 161, PROFINET 0,34 mm ² (AWG 22)
Mechanical operation	> 100 Mating cycles
Temperature range	– 40 °C / + 85 °C, PROFINET – 25 °C / + 85 °C
Rated voltage	250 V
Pollution degree	3
Rated current (40°C)	4 A
Contact plating	Au (Gold)
Material of housing	zinc diecasting nickel plated, PUR

Description

Male angled connector, CAT 5, screw clamp termination, with shielding ring, shieldable



Drawing

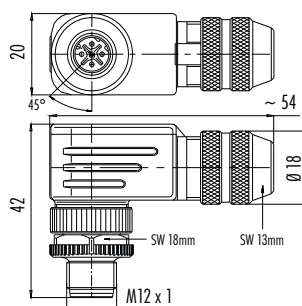

It is possible to turn and fix the contact carrier in 4 different 90° positions



Contacts

4

Cable outlet

6–8 mm

Ordering-No.

99 3729 820 04

Male angled connector, CAT 5, screw clamp termination, iris type spring, shieldable

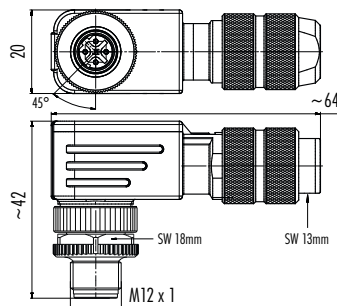

It is possible to turn and fix the contact carrier in 4 different 90° positions



4

5–8 mm

99 3727 820 04

Male angled connector, CAT 5, crimp connection, shieldable

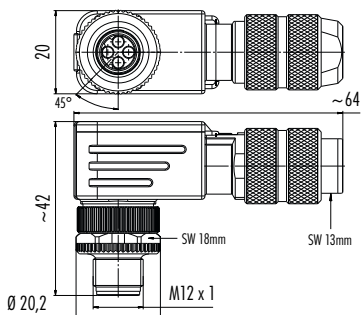

It is possible to turn and fix the contact carrier in 4 different 90° positions



4

5–8 mm

99 3721 820 04

Crimp contacts see page 159

Male cable connector, shielded, PROFINET

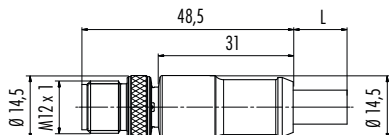

Contacts

4 x 0,34

Cable length

2 m

5 m

10 m

Ordering-No.

77 4529 0000 50704–0200

77 4529 0000 50704–0500

77 4529 0000 50704–1000

Specifications

PROFINET Cable

Contacts	4
Wire gauge	2 x 2 x AWG 22
Material jacket	PUR
Insulation of wire	Polyolefin
Design of wire (mm)	7 x 0,34 (AWG 22)
Cable diameter (mm)	6,7
Resistance of wire	55 Ω/Km (20 °C)
Temperature range cable in move	– 20 °C / + 60 °C
Temperature range cable fixed	– 40 °C / + 80 °C
Bending radius cable in move	min. 15 x d
Bending radius cable fixed	min. 5 x d
Bending radius (at 10 x D)	2 Mio.
Permitted acceleration	2 m/s ²
Traverse path horizontal 5 m/s ²	5 m
Traverse path vertical 5 m/s ²	5 m
Traverse speed	At 5 m horizontal traverse up to 200 m/min
Remark	In chain flex application or when stressed mechanically +60 °C.
Approval	PROFINET, UL/CSA
UL-style	AWM 20236

Description	Drawing	Contacts	Cable outlet	Ordering-No.
Female cable connector, CAT 5, screw clamp termination, with shielding ring, shieldable		4	6–8 mm	99 3730 810 04

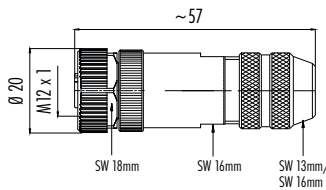

Female cable connector, CAT 5, screw clamp termination, iris type spring, shieldable		4	5–8 mm	99 3728 810 04
--	--	---	--------	----------------

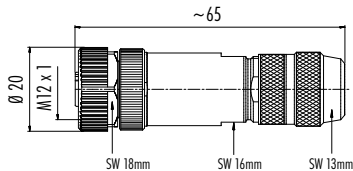

Female angled connector, CAT 5, screw clamp termination, with shielding ring, shieldable		4	5,5–8,6 mm	99 3730 820 04
--	--	---	------------	----------------

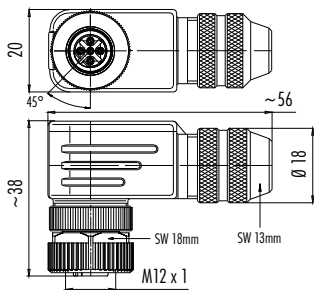

It is possible to turn and fix the contact carrier in 4 different 90° positions



Female angled connector, CAT 5, screw clamp termination, iris type spring, shieldable		4	5–8 mm	99 3728 820 04
---	--	---	--------	----------------

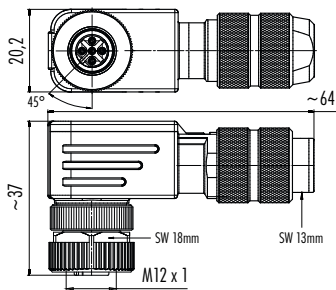

It is possible to turn and fix the contact carrier in 4 different 90° positions



Female cable connector, shielded, PROFINET	Contacts	Cable length	Ordering-No.
	4 x 0,34	2 m	77 4530 0000 50704–0200
		5 m	77 4530 0000 50704–0500
		10 m	77 4530 0000 50704–1000

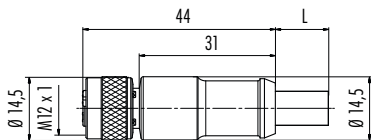

Male contact, PU 100 pieces	Wire gauge	AWG	Ordering-No.
	0,14 mm² – 0,34 mm²	26–22	61 1224 146
	0,34 mm² – 0,5 mm²	22–20	61 1154 146
	0,75 mm² – 1,0 mm²	18–16	61 1225 146
	1,0 mm² – 1,5 mm²	16	61 1226 146

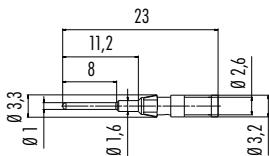

NEW

Component part drawing

Cable connectors, with shielding ring, shieldable

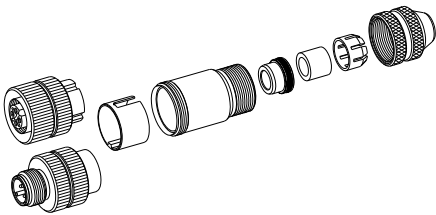

- Female insert/ Male insert
- Insulating sleeve tightly built into coupling sleeve
- Shielding ring
- O-ring
- Seal
- Pinch ring
- Pressing screw

Cable connectors, with iris type spring, shieldable

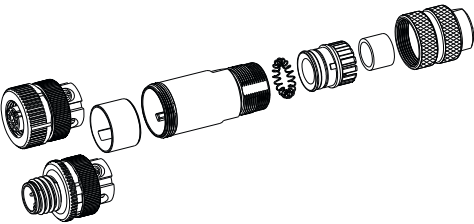

- Female insert/ Male insert
- Insulating sleeve, Sleeve, Pressing spring, O-ring, Pinch ring, Seal, Pressing screw are premounted

Angled connectors, shieldable

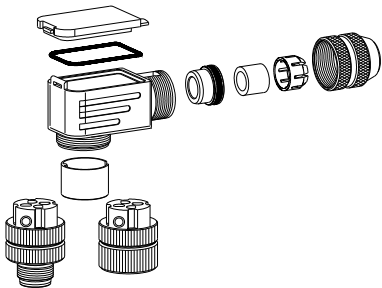

- Female insert/ Male insert
- Insulating sleeve tightly built into coupling sleeve
- Housing
- Seal
- Cover
- Shielding ring
- O-ring
- Seal
- Pinch ring
- Pressing screw

Angled connectors, with iris type spring, shieldable

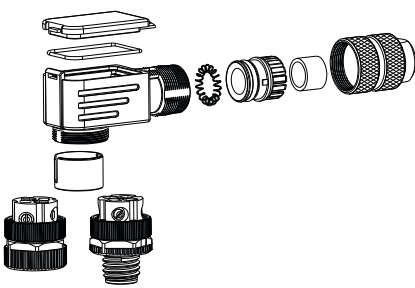

- Female insert/ Male insert
- Insulating sleeve, Housing, Pressing spring, O-ring, Pinch ring, Seal, Pressing screw are premounted
- O-ring
- Cover

Contact arrangements male insert (mating side)

4 contacts

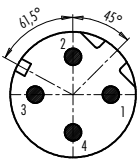

Contact arrangements female insert (mating side)

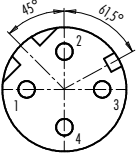

Colour of wire, moulded cable and panel mount connectors

- 1 white-orange
- 2 orange
- 3 white-green
- 4 green
- Shield = Coupling ring

Description

Male receptacle for PCB assembly



Drawing

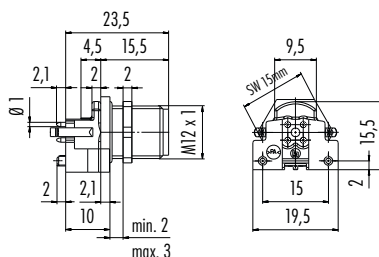

PCB thickness: 1,6 mm

View of mating side



Contacts

Ordering-No.

4	99 3731 200 04
	99 3731 201 04 with shielding sheet

Male angled receptacle for PCB assembly

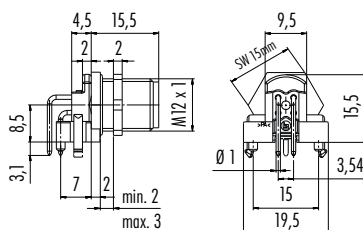

PCB thickness: 1,6 mm

View of mating side



4

99 3731 202 04
99 3731 203 04 with shielding sheet

Male panel mount connector, SMT, with housing, shieldable

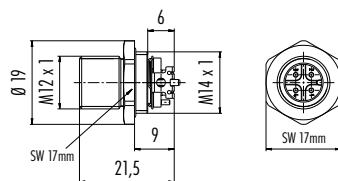

Contacts

Mounting height

Ordering-No.

4	9 mm	99 3731 401 04
---	------	----------------

NEW

Male panel mount connector, SMT, with housing, shieldable

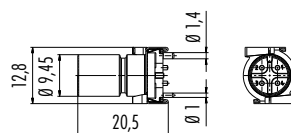

4

–

NEW

NEW

Male panel mount connector M16, with PROFINET-cable, shielded

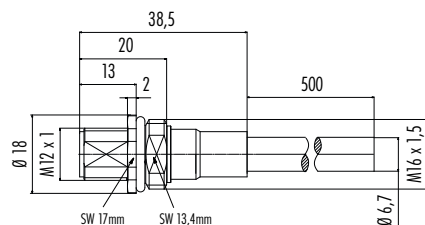

Contacts

Cable length, PUR

Fix. thread

Ordering-No.

4	0,5 m	M16 x 1,5	70 3733 705 04
---	-------	-----------	----------------

Male panel mount connector PG 9, front fastened, with PROFINET-cable, shielded

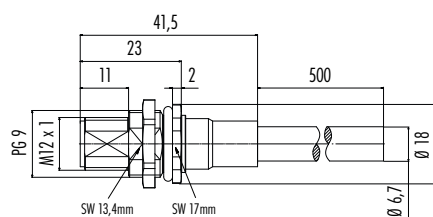

Hexagonal nut enclosed loose

4

0,5 m

PG 9

70 3733 706 04

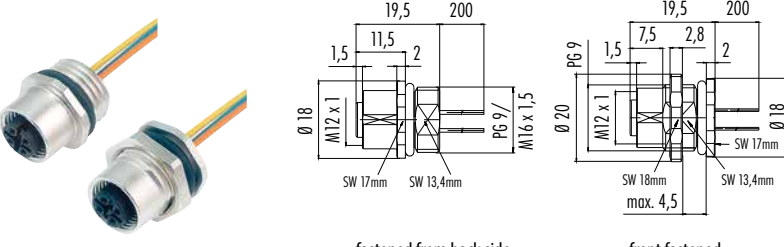
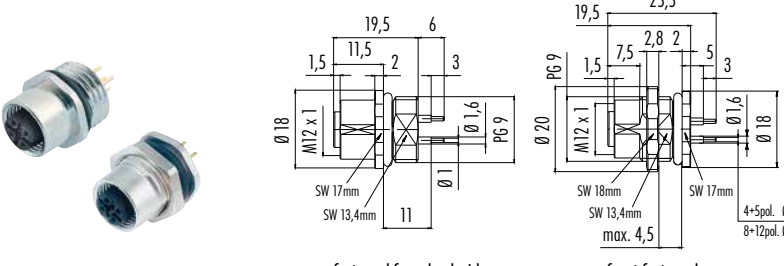
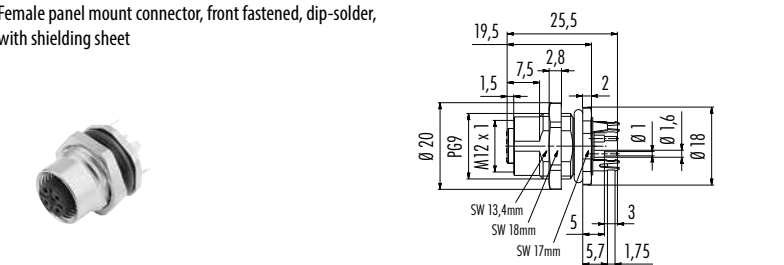
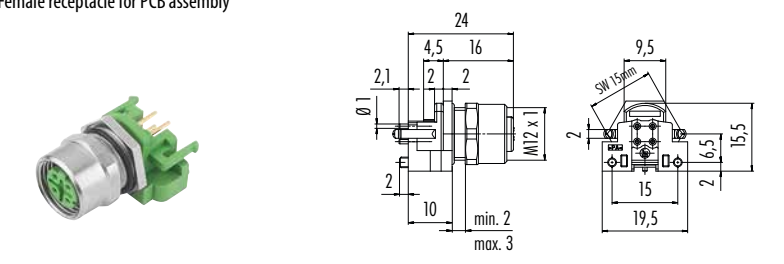
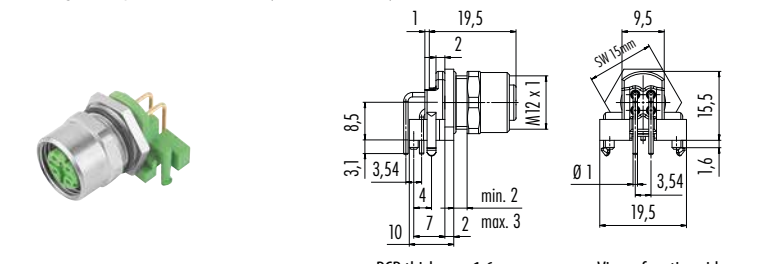
Description		Drawing		Contacts	Fix. thread	Fastened from back side	Front fastened
Female panel mount connector with single wires				4	PG 9	76 0136 0011 00404-0200 max. 76 0536 1011 00404-0200	
					M16 x 1,5	76 0236 0011 00404-0200	-
Female panel mount connector, dip-solder				4	PG 9	86 0136 0000 00404	86 0536 1000 00404
Female panel mount connector, front fastened, dip-solder, with shielding sheet				4	PG 9	86 0536 1120 00404	
Female receptacle for PCB assembly				4		99 3732 200 04	
						99 3732 201 04	with shielding sheet
Female angled receptacle for PCB assembly, for PCB assembly				4		99 3732 202 04	
						99 3732 203 04	with shielding sheet
Specifications		Panel mount connector					
Contacts		4					
Wire gauge		max. 0,25 mm² (max. AWG 24), AWG 22					
Mechanical operation		> 100 Mating cycles					
Temperature range		- 40 °C / + 85 °C					
Rated voltage		250 V					
Pollution degree		3					
Rated current (40°C)		4 A					
Contact plating		Au (Gold)					
Material of housing		CuZn (brass nickel plated), zinc diecasting nickel plated					

Panel cut out

Panel mount connector

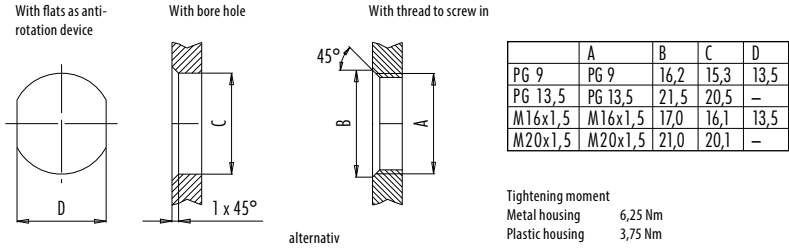

Panel mount connector, front fastened

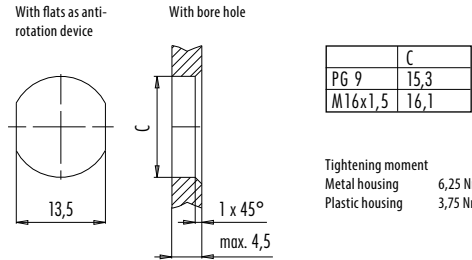

Panel mount connector, positioning possible

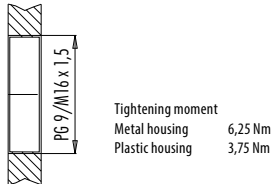

Panel mount connector, screw clamp termination

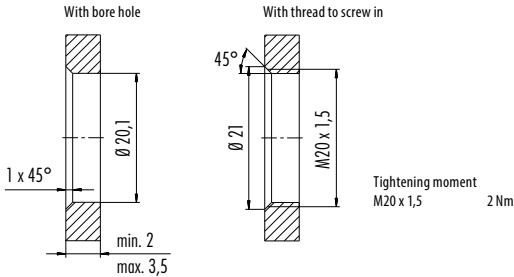

Panel mount connector, with thread M12

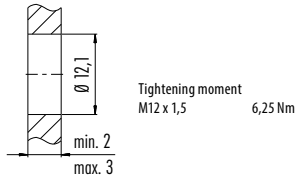

Lead-through for control cabinet

