



- Screw termination M16
- Degree of protection IP67
- Solder-/Crimp-/Screw clamp termination
- Moulded versions
- shieldable
- Acc. to DIN EN 61076-2-106
- AISG compatible

c **RU** **us** certified under number
20120329-E30 2391

Description	Drawing	Contacts	Cable outlet	Shielding ring	Cable clamp
Male cable connector with shielding ring/cable clamp, shieldable, solder termination		3 DIN	4-6 mm	99 5105 15 03	99 5105 00 03
		4		99 5109 15 04	99 5109 00 04
		5		99 5113 15 05	99 5113 00 05
		6 DIN		99 5121 15 06	99 5121 00 06
		7		99 5125 15 07	99 5125 00 07
		8 DIN		99 5171 15 08	99 5171 00 08
		12		99 5129 15 12	99 5129 00 12
		19		99 5461 15 19	99 5461 00 19

Male cable connector with shielding ring/cable clamp, shieldable, solder termination		3 DIN	6-8 mm	99 5605 15 03	99 5605 00 03
		4		99 5609 15 04	99 5609 00 04
		5		99 5613 15 05	99 5613 00 05
		6 DIN		99 5621 15 06	99 5621 00 06
		7		99 5625 15 07	99 5625 00 07
		8 DIN		99 5671 15 08	99 5671 00 08
		12		99 5629 15 12	99 5629 00 12
		19		99 5661 15 19	99 5661 00 19

Description	Drawing	Contacts	Cable outlet	Screw clamp	Crimp
Male cable connector with cable clamp, screw clamp connection/crimp connection, shieldable		3 DIN	4-6 mm	99 5105 210 03	-
		4		99 5109 210 04	99 5109 700 04
		5		99 5113 210 05	99 5113 700 05
		6 DIN		-	99 5121 700 06
		7		-	99 5125 700 07
		8 DIN		-	99 5171 700 08

Crimp and strip contacts see page 56

Male cable connector with cable clamp, screw clamp connection/crimp connection, shieldable		3 DIN	6-8 mm	99 5605 210 03	-
		4		99 5609 210 04	99 5609 700 04
		5		99 5613 210 05	99 5613 700 05
		6 DIN		-	99 5621 700 06
		7		-	99 5625 700 07
		8 DIN		-	99 5671 700 08

Crimp and strip contacts see page 56

Specifications

Contacts	3 DIN	4	5	6 DIN	7	8 DIN	12	19	
Wire gauge	max. 0,75 mm ² (max. AWG 20)						max. 0,25 mm ² (max. AWG 24)		
Mechanical operation	> 500 Mating cycles								
Temperature range	- 40 °C / + 95 °C								
Rated voltage	250 V (32 V)				125 V (32 V)		60 V (32 V)		
Pollution degree	1 (2) ¹⁾								
Rated current (40°C)	7 A		6 A			5 A		3 A	
Contact plating	Ag (Silver)						Au (Gold)		
Material of housing	CuZn (brass, nickel plated)								

Description

Drawing

Contacts

Cable outlet

Ordering-No.

Male cable connector, short version, solder termination

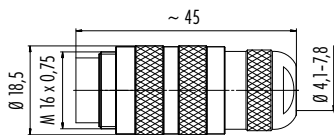

3 DIN	4-8 mm	99 5105 40 03
4		99 5109 40 04
5		99 5113 40 05
6 DIN		99 5121 40 06
7		99 5125 40 07
8 DIN		99 5171 40 08
12		99 5129 40 12
19		99 5461 40 19

Male cable connector, short version, crimp connection



4	4-8 mm	99 5109 740 04
5		99 5113 740 05
6 DIN		99 5121 740 06
7		99 5125 740 07
8 DIN		99 5171 740 08

Crimp and strip contacts see page 56

Male angled connector, shieldable, solder termination

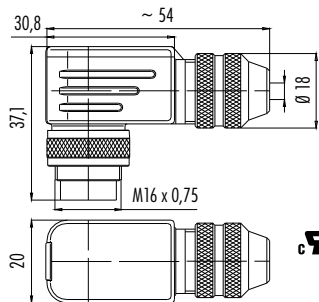

Contacts	Cable outlet 4-6 mm	Cable outlet 6-8 mm
3 DIN	99 5105 75 03	99 5605 75 03
4	99 5109 75 04	99 5609 75 04
5	99 5113 75 05	99 5613 75 05
6 DIN	99 5121 75 06	99 5621 75 06
7	99 5125 75 07	99 5625 75 07
8 DIN	99 5171 75 08	99 5671 75 08
12	99 5129 75 12	99 5629 75 12
19	99 5461 75 19	99 5661 75 19

Male angled connector, shieldable, crimp connection



4	99 5109 750 04	99 5609 750 04
5	99 5113 750 05	99 5613 750 05
6 DIN	99 5121 750 06	99 5621 750 06
7	99 5125 750 07	99 5625 750 07
8 DIN	99 5171 750 08	99 5671 750 08

Crimp and strip contacts see page 56

Male cable connector, moulded

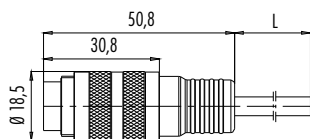

Contacts	Cable length, PUR	Unshielded	Shielded
5 x 0,25	2 m	79 6013 20 05	79 6113 20 05
6 DIN x 0,25		-	79 6117 20 06
8 DIN x 0,25		79 6071 20 08	79 6171 20 08
12 x 0,25		79 6029 20 12	79 6129 20 12

Male angled connector, moulded

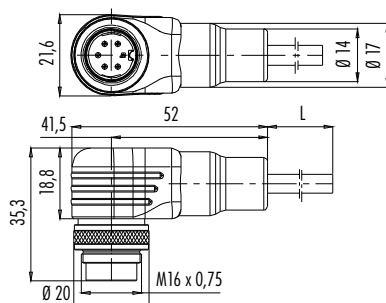

5 x 0,25	2 m	79 6213 200 05	79 6313 200 05
6 DIN x 0,25		-	79 6317 200 06
8 DIN x 0,25		79 6271 200 08	79 6371 200 08
12 x 0,25		79 6229 200 12	79 6329 200 12

Description	Drawing	Contacts	Cable outlet	Shielding ring	cable clamp
Female cable connector with shielding ring/cable clamp, shieldable		3 DIN	4-6 mm	99 5106 15 03	99 5106 00 03
		4		99 5110 15 04	99 5110 00 04
		5		99 5114 15 05	99 5114 00 05
		6 DIN		99 5122 15 06	99 5122 00 06
		7		99 5126 15 07	99 5126 00 07
		8 DIN		99 5172 15 08	99 5172 00 08
		12		99 5130 15 12	99 5130 00 12
		19		99 5462 15 19	99 5462 00 19

Female cable connector with shielding ring/cable clamp, shieldable		3 DIN	6-8 mm	99 5606 15 03	99 5606 00 03
		4		99 5610 15 04	99 5610 00 04
		5		99 5614 15 05	99 5614 00 05
		6 DIN		99 5622 15 06	99 5622 00 06
		7		99 5626 15 07	99 5626 00 07
		8 DIN		99 5672 15 08	99 5672 00 08
		12		99 5630 15 12	99 5630 00 12
		19		99 5662 15 19	99 5662 00 19

Description	Drawing	Contacts	Cable outlet	Screw clamp	Crimp
Female cable connector with cable clamp, screw clamp connection/crimp connection, shieldable		3 DIN	4-6 mm	99 5106 210 03	-
		4		99 5110 210 04	99 5110 700 04
		5		99 5114 210 05	99 5114 700 05
		6 DIN		-	99 5122 700 06
		7		-	99 5126 700 07
		8 DIN		-	99 5172 700 08

Crimp and strip contacts see page 56

Female cable connector with cable clamp, screw clamp connection/crimp connection, shieldable		3 DIN	6-8 mm	99 5606 210 03	-
		4		99 5610 210 04	99 5610 700 04
		5		99 5614 210 05	99 5614 700 05
		6 DIN		-	99 5622 700 06
		7		-	99 5626 700 07
		8 DIN		-	99 5672 700 08

Description	Drawing	Contacts	Cable outlet	Ordering-No.
Female cable connector, short version, solder termination		3 DIN	4-8 mm	99 5106 40 03
		4		99 5110 40 04
		5		99 5114 40 05
		6 DIN		99 5122 40 06
		7		99 5126 40 07
		8 DIN		99 5172 40 08
		12		99 5130 40 12
		19		99 5462 40 19

Female cable connector, short version, crimp connection		4	4-8 mm	99 5110 740 04
		5		99 5114 740 05
		6 DIN		99 5122 740 06
		7		99 5126 740 07
		8 DIN		99 5172 740 08

Description

Female angled connector, shieldable



Drawing

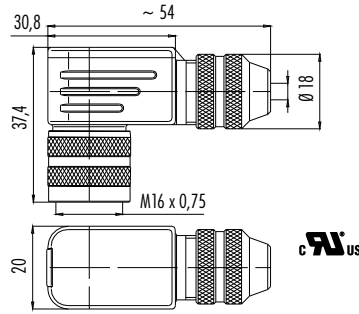

Contacts

Cable outlet 4–6 mm

Cable outlet 6–8 mm

3 DIN	99 5106 75 03	99 5606 75 03
4	99 5110 75 04	99 5610 75 04
5	99 5114 75 05	99 5614 75 05
6 DIN	99 5122 75 06	99 5622 75 06
7	99 5126 75 07	99 5626 75 07
8 DIN	99 5172 75 08	99 5672 75 08
12	99 5130 75 12	99 5630 75 12
19	99 5462 75 19	99 5662 75 19

Female angled connector, crimp connection, shieldable



4	99 5110 75 04	99 5610 75 04
5	99 5114 75 05	99 5614 75 05
6 DIN	99 5122 75 06	99 5622 75 06
7	99 5126 75 07	99 5626 75 07
8 DIN	99 5172 75 08	99 5672 75 08

Crimp and strip contacts see page 56

Female cable connector, moulded

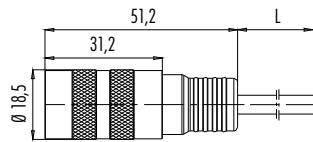

Contacts	Cable length, PUR	Unshielded	Shielded
5 x 0,25	2 m	79 6014 20 05	79 6114 20 05
6 DIN x 0,25		–	79 6118 20 06
8 DIN x 0,25		79 6072 20 08	79 6172 20 08
12 x 0,25		79 6030 20 12	79 6130 20 12

Female angled connector, moulded

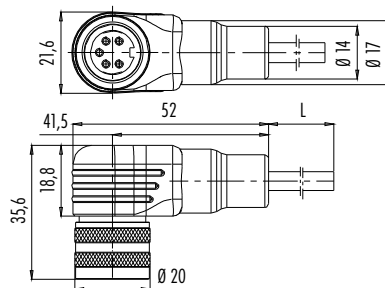

5 x 0,25	2 m	79 6214 200 05	79 6314 200 05
6 DIN x 0,25		–	79 6318 200 06
8 DIN x 0,25		79 6272 200 08	79 6372 200 08
12 x 0,25		79 6230 200 12	79 6330 200 12

Component part drawing

Cable connectors, solder termination, with shielding ring

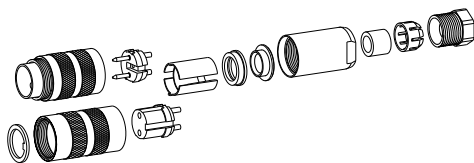

- Male ring nut/
- Female ring nut with seal
- Female insert/
- Male insert
- Distance sleeve
- Shielding ring
- Shield clamping ring
- Sleeve
- Seal
- Pinch ring
- Pressing screw

Cable connectors, solder termination, with cable clamp

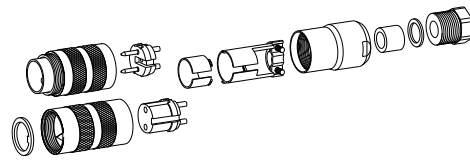

- Male ring nut/
- Female ring nut with seal
- Female insert/
- Male insert
- Cable clamp
- Sleeve
- Seal
- Thrust collar
- Pressing screw

Cable connectors with screw clamp connection

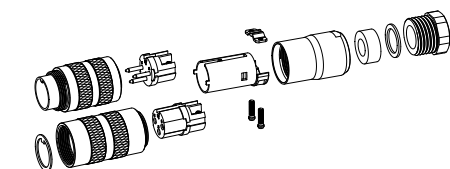

- Male ring nut/
- Female ring nut with seal
- Female insert/
- Male insert
- Cable clamp
- Sleeve
- Seal
- Thrust collar
- Pressing screw

Cable connectors with crimp connection

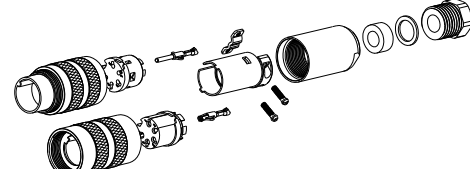

- Male ring nut/
- Female ring nut
- Female insert/
- Male insert
- Female contact/
- Male contact
- Cable clamp
- Sleeve
- Seal
- Thrust collar
- Pressing screw

Component part drawing

Cable connectors, short version

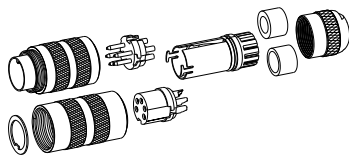

Male ring nut/
Female ring nut with seal
Female insert/
Male insert
Cable clamp
Seal 4–6 mm/6–8 mm
Pressing screw

Angled connectors

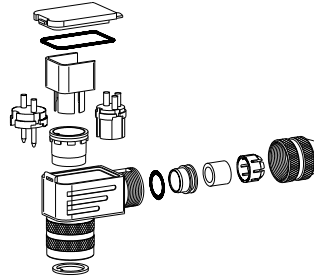

Male ring nut and housing/
Female ring nut and housing with seal
Positioning sleeve with O-ring 12,5 x 1,1
Female insert/
Male insert
Distance sleeve, Shaped seal, Cover
O-ring 9 x 1,5
Shielding ring, Seal
Pinch ring, Pressing screw
Cable outlet adjustable in 4 positions

Description

Drawing

Male cable connector, solder termination

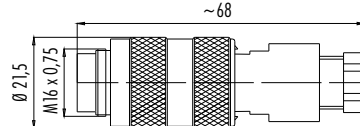

Contacts

Cable outlet 4–6 mm

Cable outlet 6–8 mm

3 DIN	09 0105 25 03	09 0105 70 03
4	09 0109 25 04	09 0109 70 04
5	09 0113 25 05	09 0113 70 05
6 DIN	09 0121 25 06	09 0121 70 06
7	09 0125 25 07	09 0125 70 07
8 DIN	09 0171 25 08	09 0171 70 08
12	09 0129 25 12	09 0129 70 12
19	09 0461 25 19	09 0461 70 19

Male angled connector, solder termination

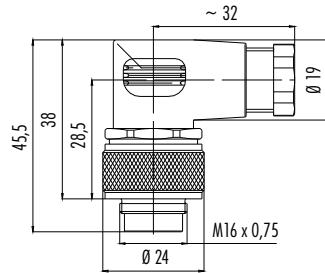

3 DIN	99 0105 106 03	99 0105 75 03
4	99 0109 106 04	99 0109 75 04
5	99 0113 106 05	99 0113 75 05
6 DIN	99 0121 106 06	99 0121 75 06
7	99 0125 106 07	99 0125 75 07
8 DIN	99 0171 106 08	99 0171 75 08
12	99 0129 106 12	99 0129 75 12
19	99 0461 106 19	99 0461 75 19

Female cable connector, solder termination

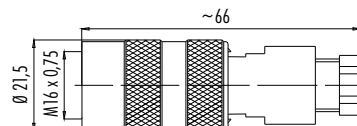

3 DIN	09 0106 25 03	09 0106 70 03
4	09 0110 25 04	09 0110 70 04
5	09 0114 25 05	09 0114 70 05
6 DIN	09 0122 25 06	09 0122 70 06
7	09 0126 25 07	09 0126 70 07
8 DIN	09 0172 25 08	09 0172 70 08
12	09 0130 25 12	09 0130 70 12
19	09 0462 25 19	09 0462 70 19

Female angled connector, solder termination

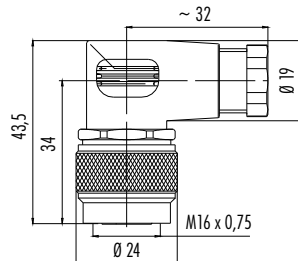

3 DIN	99 0106 106 03	99 0106 75 03
4	99 0110 106 04	99 0110 75 04
5	99 0114 106 05	99 0114 75 05
6 DIN	99 0122 106 06	99 0122 75 06
7	99 0126 106 07	99 0126 75 07
8 DIN	99 0172 106 08	99 0172 75 08
12	99 0130 106 12	99 0130 75 12
19	99 0462 106 19	99 0462 75 19

Component part drawing

Cable connectors

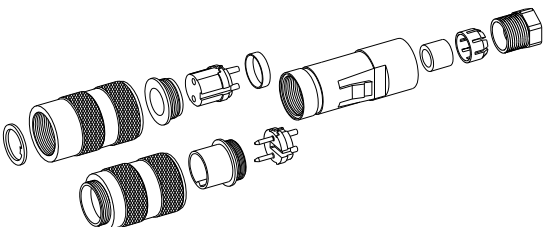

Male ring nut/
Female ring nut with seal
Female insert assembled/
Male insert assembled
Housing
Seal
Pinch ring
Pressing screw

Angled connectors

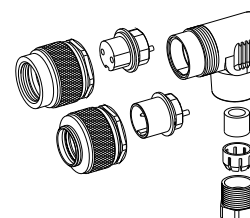

Male ring nut/
Female ring nut
Female insert/
Male insert
Angled housing
Seal
Pinch ring
Pressing screw
Cable outlet adjustable in 4 positions

Description

Drawing

Contacts

Male panel mount connector solder

Male panel mount connector with single wires

Male panel mount connector, solder/with single wires (200 mm), AWG 22

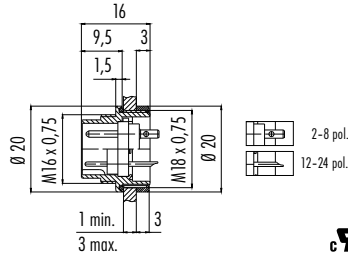

NEW

3 DIN	09 0107 00 03	–
4	09 0111 00 04	09 0111 702 04
5	09 0115 00 05	09 0115 702 05
6 DIN	09 0123 00 06	09 0123 702 06
7	09 0127 00 07	09 0127 702 07
8 DIN	09 0173 00 08	09 0173 702 08
12	09 0131 00 12	–
19	09 0463 00 19	–

Male panel mount connector, solder, front fastened/with single wires (200 mm), AWG 22

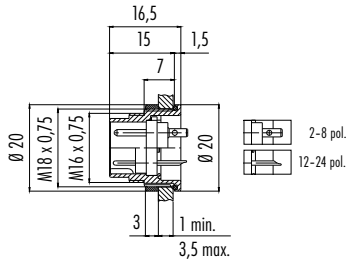

NEW

3 DIN	09 0107 80 03	–
4	09 0111 80 04	09 0111 782 04
5	09 0115 80 05	09 0115 782 05
6 DIN	09 0123 80 06	09 0123 782 06
7	09 0127 80 07	09 0127 782 07
8 DIN	09 0173 80 08	09 0173 782 08
12	09 0131 80 12	–
19	09 0463 80 19	–

Male panel mount connector, dip-solder, front fastened

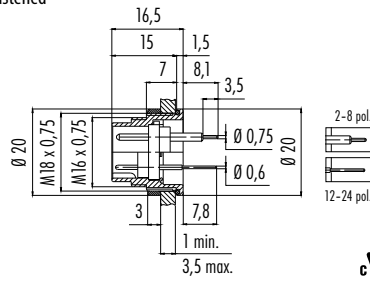

3 DIN	09 0107 90 03	–
4	09 0111 90 04	–
5	09 0115 90 05	–
6 DIN	09 0123 90 06	–
7	09 0127 90 07	–
8 DIN	09 0173 90 08	–
12	09 0131 90 12	–
19	09 0463 90 19	–

Male panel mount connector, dip-solder, front fastened, with shield connection

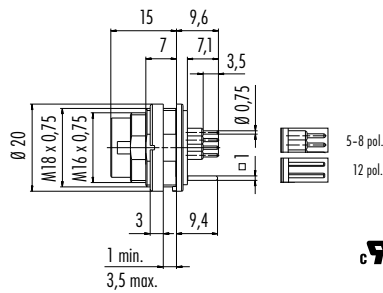

5	09 0115 290 05	–
6 DIN	09 0123 290 06	–
8 DIN	09 0173 290 08	–
12	09 0131 290 12	–
19	09 0463 290 19	–

Male panel mount connector, crimp

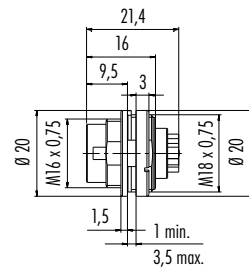

4	09 0111 700 04	–
5	09 0115 700 05	–
6 DIN	09 0123 700 06	–
7	09 0127 700 07	–
8 DIN	09 0173 700 08	–

Crimp and strip contacts see page 56

Male panel mount connector, crimp, front fastened

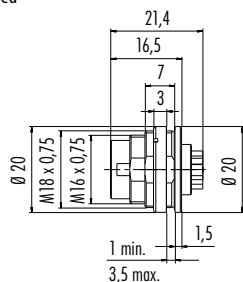

4	09 0111 780 04	–
5	09 0115 780 05	–
6 DIN	09 0123 780 06	–
7	09 0127 780 07	–
8 DIN	09 0173 780 08	–

Crimp and strip contacts see page 56

Description	Drawing	Contacts	Female panel mount connector solder	Female panel mount connector with single wires
Female panel mount connector, solder/with single wires (200 mm), AWG 22		3 DIN 4 5 6 DIN 7 8 DIN 12 19	09 0108 00 03 09 0112 00 04 09 0116 00 05 09 0124 00 06 09 0128 00 07 09 0174 00 08 09 0132 00 12 09 0464 00 19	– 09 0112 702 04 09 0116 702 05 09 0124 702 06 09 0128 702 07 09 0174 702 08 – –
Female panel mount connector, solder, front fastened/with single wires (200 mm), AWG 22		3 DIN 4 5 6 DIN 7 8 DIN 12 19	09 0108 80 03 09 0112 80 04 09 0116 80 05 09 0124 80 06 09 0128 80 07 09 0174 80 08 09 0132 80 12 09 0464 80 19	– 09 0112 782 04 09 0116 782 05 09 0124 782 06 09 0128 782 07 09 0174 782 08 – –
Female panel mount connector, dip-solder, front fastened		3 DIN 4 5 6 DIN 7 8 DIN 12 19	09 0108 90 03 09 0112 90 04 09 0116 90 05 09 0124 90 06 09 0128 90 07 09 0174 90 08 09 0132 90 12 09 0464 90 19	– – – – – – – –
Female panel mount connector, crimp		4 5 6 DIN 7 8 DIN	09 0112 700 04 09 0116 700 05 09 0124 700 06 09 0128 700 07 09 0174 700 08	– – – – –
Female panel mount connector, crimp, front fastened		4 5 6 DIN 7 8 DIN	09 0112 780 04 09 0116 780 05 09 0124 780 06 09 0128 780 07 09 0174 780 08	– – – – –
Male panel mount connector/Female panel mount connector with flexible PCB, front fastened		7 8 DIN 12	09 0127 65 07 09 0173 65 08 09 0131 65 12 single-row 09 0131 66 12 double-row	09 0128 65 07 09 0174 65 08 09 0132 65 12 single-row 09 0132 66 12 double-row

Contact arrangements male insert (mating side)

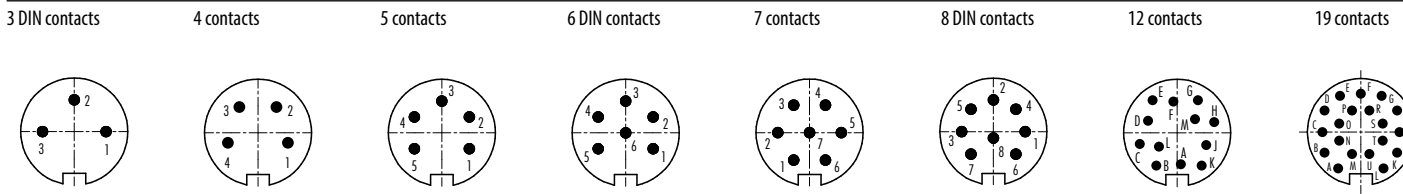

Contact arrangements female insert (mating side)

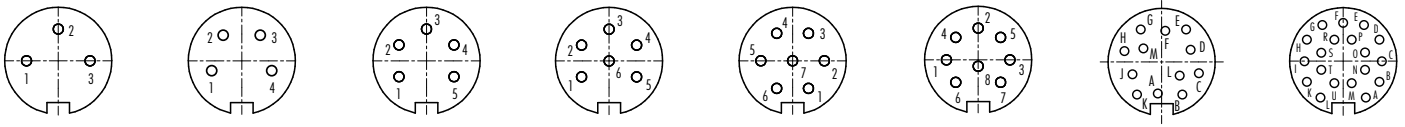

Panel cut out

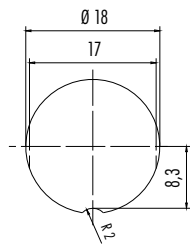

Recommended drill holes

2 – 8 contacts 1,1 mm
12 – 24 contacts 0,8 mm

Colour of wires of moulded cable connectors

5 contacts	6 contacts	8 contacts	12 contacts
1 white	1 red	1 white	A white
2 brown	2 black	2 brown	B brown
3 blue	3 yellow	3 green	C green
4 black	4 blue	4 yellow	D yellow
5 grey	5 white	5 grey	E grey
	6 green	6 pink	F pink
		7 blue	G blue
		8 red	H red

Colour of wires of panel mount connectors

4–8 contacts
1 white
2 brown
3 green
4 yellow
5 grey
6 pink
7 blue
8 red

Description

Drawing

Male contact, PU 50 pieces

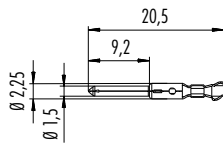

Female contact, PU 50 pieces

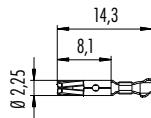

Strip contact (Male)



Contact-Ø	Insulating-Ø	Wire gauge	PU	Pieces	Ordering-No.
1,5 mm	1,0–2,0 mm	0,14–0,25 mm ²	Single	50	61 0799 085 00
			Strip	200	65 0799 085 01
			Strip	2000	65 0799 085 02
	1,6–2,1 mm	0,35–0,5 mm ²	Single	50	61 0795 085 00
			Strip	200	65 0795 085 01
			Strip	2000	65 0795 085 02

Strip contact (Female)



1,5 mm	1,0–2,0 mm	0,14–0,25 mm ²	Single	50	61 0800 085 00
			Strip	200	65 0800 085 01
			Strip	2000	65 0800 085 02
	1,6–2,1 mm	0,35–0,5 mm ²	Single	50	61 0797 085 00
			Strip	200	65 0797 085 01
			Strip	2000	65 0797 085 02

Description

Drawing

Ordering-No.

Protection cap for male cable connectors

08 1077 000 000

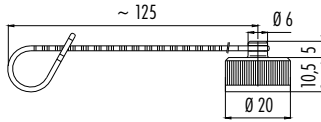

Protection cap for female cable connectors

08 1078 000 000

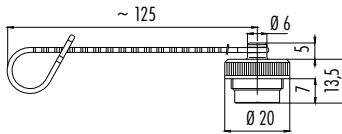

Protection cap for male panel mount connectors

Hole-Ø D

Ordering-No.

3 mm 08 1079 000 000

18 mm 08 2670 000 000

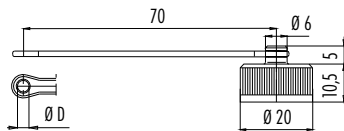
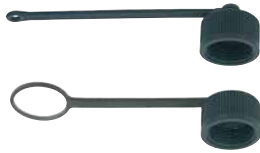

Protection cap for female panel mount connectors

3 mm 08 1080 000 000

18 mm 08 2671 000 000

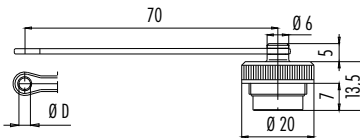

Ordering-No.

Mounting spanner for panel mount connectors

07 0010 001

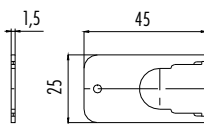

Rectangular flange for panel mount connectors



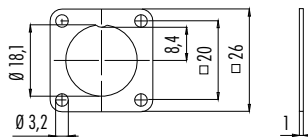





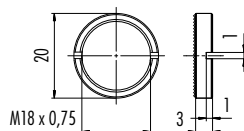

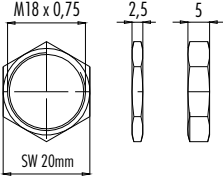

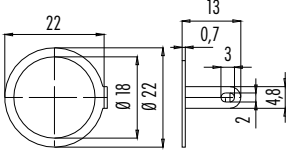
08 0045 000 001

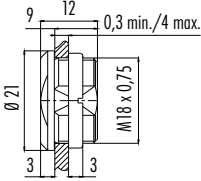

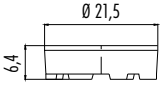
Ring nut for fixing thread

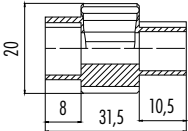
01 0010 001 with knurled screw



Description	Drawing	Thickness	Ordering-No.
<p>Hexagonal nut</p> 		<p>2,5 mm 5 mm</p>	<p>01 0146 001 01 5006 001</p>
<p>Solder eye ring</p> 		<p>Ordering-No. 04 0186 009</p>	
<p>Blind plug</p> 		<p>08 2668 000 001</p>	
<p>Distance sleeve for panel mount connectors, dip-solder version</p> 	 <p>PCB thickness: max. 1,5 mm</p>	<p>02 0007 000</p>	
<p>Mounting spanner for straight, shieldable cable connectors</p> 		<p>02 1785 000</p>	
<p>Crimping tool for single contacts</p> 	<p>Crimping tool for strip contacts</p> 	<p>66 0001 014 100 67 0001 014 100</p>	
<p>Extraction tool for crimp contacts</p> 		<p>07 0088 000</p>	